



# Red Grade *PROFESSIONAL*

## INSTRUCTION MANUAL

**Plus+**

Model: PSD

Type: 08-CH



**MUST READ  
BEFORE USING!**



# **! Attention !**

- The feeling of warmth produced by the Thermalution® heated bodysuit is dependent on the weather conditions, environment and heat sensitivity of each user. We suggest wearing a shirt under the Thermalution® heated bodysuit if you feel too warm when it is directly on your skin.
- Shut off power and disconnect battery immediately if discomfort occurs.
- Make sure disconnect battery after power has been turned off.
- Disconnect the batteries from the suit before storing. Such preventive safety measures reduce the risk of starting the heated under suit accidentally.
- Please lay the bodysuit on a flat surface after you take it off.
- Never bend or twist the bodysuit.
- Do not put weight on top of the bodysuit.
- Please flush out the salty water from the bodysuit or any grime on the connectors, then store away after it is fully dry. Keep it in a cool and dry place; away from the sun.
- Do not tumble dry. No spin or bleach.

# INDEX

---

P.3 .....	<b>Thermalution Red Grade</b>
P.5 .....	<b>Red Grade introduction</b>
P.6 .....	<b>Accessories &amp; specifications</b>
P.8 .....	<b>Red Grade characteristics</b>
P.9 .....	<b>How to connect batteries onto the bodysuit</b>
P.10 .....	<b>How to wear the bodysuit</b>
P.11 .....	<b>How to wear the forearm strap</b>
P.12 .....	<b>How to operate the controller</b>
P.14 .....	<b>How to connect the charging dock</b>
P.17 .....	<b>Washing instructions</b>
P.18 .....	<b>How to charge the batteries</b>
P.20 .....	<b>How to store the undersuit properly</b>
P.22 .....	<b>FAQ</b>
P.25 .....	<b>Warning</b>
P.26 .....	<b>Batteries</b>
P.27 .....	<b>Battery handling precautions</b>



## Thermalution

# Red Grade *PROFESSIONAL*

---

### ➡ Power Heated Bodysuit

Thermalution<sup>®</sup> Red Grade is the latest technology that facilitates you to stay warm and pleasant in oceans up to 100 meters (300ft) deep. You can wear the Thermalution<sup>®</sup> Red Grade under your dry suit

Thermalution<sup>®</sup> Red Grade has a wireless temperature micro-controller with three levels of temperature control. It is very easy to adjust the temperature during your aquatic activities. Thermalution<sup>®</sup> Red Grade apparel will uplift your game to a truly sensational experience.

The high capacity lithium polymer battery has been tested under water to be waterproof.

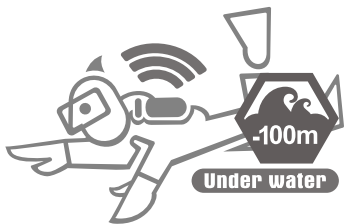



**WIRELESS  
CONTROLLER**



**WATER PROOF**



**3 level setting  
temperature**



**Powered heating**



**Durable  
water repellent**



**Temperature with  
micro-controller**



**500  
charges**

**Model : PSD  
Type : 08-CH**

**MADE IN TAIWAN**



**Under water**



**HEATING ZONE**



**WIRELESS  
CHARGING**

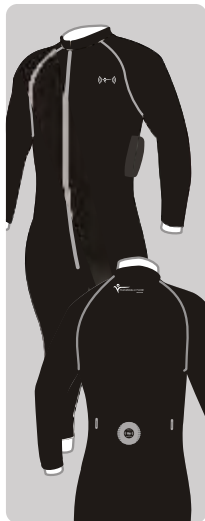

**FCC ID :  
2AD8XSPE-005**

# Red Grade - Plus+ Introduction

The Thermalution® Red Grade needs to be worn underneath a drysuit in order to function properly.

---

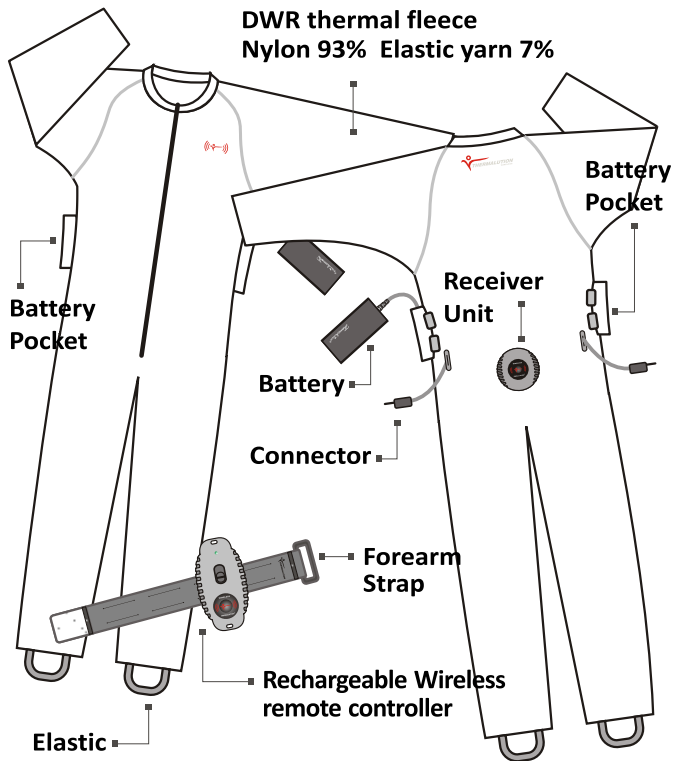

# Accessories & Specifications

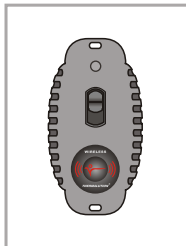

## Rechargeable Wireless remote Controller 1pc.

Model : SPE Type : 005-F

3 Settings:

Light Color	Green	Orange	Red
Temperature	Low	Mid	High

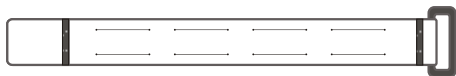

## Forearm Strap

Model No.:

COC-011-C

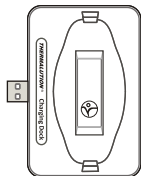

## Wireless charging dock

Model : SPE Type : 004-K

Input from SPE-004-J / SPE-004-L only

- ! Please do not use ordinary USB cable or any type of USB power adaptor to power up.



When charge the remote controller, please make sure the controller has been put on the charging duck in locking position, in order to achieve normal charging performance

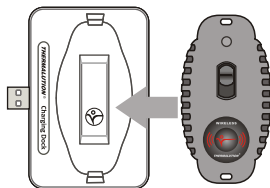

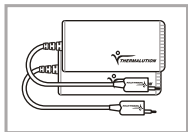

### **Lithium Polymer Battery 2pc.**

**Model : SPE    Type : 002-E**

**Output : 7.4V / 4400mAh / 32.6Wh**

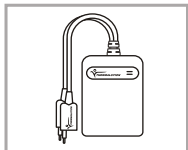

### **Battery Charger 1pc.**

**Model : SPE    Type : 004-J**

**Input : 12VDC / 1A**

**Output : 8.4VDC / 0.5A x 2**

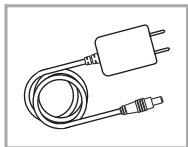

### **Power Adaptor 1set. (For charger)**

**Model : COE    Type : 010-C**

**Input : AC 100-240V**

**Output : DC 12V / 1A**

## **Optional**

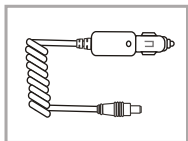

Sold separately (For battery charger)

### **Car Power Adaptor 1pc.**

**Model : COE    Type : 013-A**

**Input : 12VDC    Output : 12V / 2A**

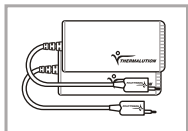

### **Lithium Polymer Battery 2pc.**

**Model : SPE    Type : 002-C**

**Input : 7.4V / 2200mAh / 16.3Wh**

Thermalution

# Red Grade *PROFESSIONAL*

---

## ➔ Characteristics

- Suitable for depths up to 100m (300ft) deep.
- Non-metallic heating panel positioned on the back to warm up your core area.
- Wireless temperature micro-controller with on/off switch and 3 temperature settings and lights indication.
- Built in microchip within controller providing extra stability for temperature control.
- Heats up within minutes.
- Heat lasting 180-240 minutes.
- High capacity lithium-polymer batteries.
- Batteries could be recharged for 500 times.
- 100V~240V Universal Dual battery charger.
- Therapeutic Far Infrared Technology (FIR).
- Fabric:  
**DWR thermal fleece** - Nylon 93% Elastic yarn 7%  
( DWR = durable water repellent )

# How to Connect Batteries onto the Bodysuit:

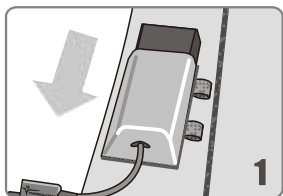

Push the battery connector through the hole at the bottom of the battery pocket. Place the battery inside the battery pocket.

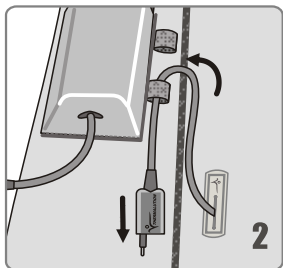

Push the bodysuit power connector through the side hole first as shown in the diagram.

⚠ Please switch off the remote controller and remove batteries immediately after diving.

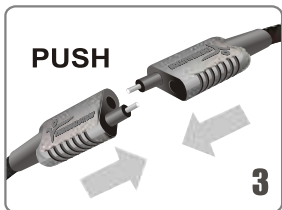

Connect both connectors.

⚠ Connecting batteries with each other is absolutely prohibited! It may cause serious damage to the battery themselves.

! Connect the battery cables and place the batteries in the battery pockets before you wear the bodysuit.

! Once you have connected both batteries the receiver will vibrate for 1 sec as a confirmation of connection.

! Remove the battery connections once you get out of the water.

# How to Wear the Bodysuit:

- Thermalution® Red Grade heated bodysuit functions as a thermal layer under the drysuit.
- Thermalution® Red Grade heated bodysuit needs to be worn underneath a drysuit in order to function properly.
- To ensure best heating performance, please always charge up the batteries before use.
- Wireless temperature micro-controller needs to be fastened by the forearm strap.



- The feeling of warmth produced by the Thermalution® heated bodysuit is dependent on the weather conditions, environment and heat sensitivity of each user. We suggest wearing a shirt under the Thermalution® heated bodysuit if you feel too warm when it is directly on your skin.
- Shut off power and unplug battery immediately if discomfort occurs.



## How to wear the Forearm Strap:

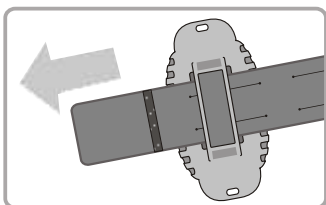
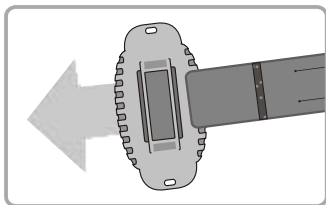

Insert the forearm strap through the tunnel of the controller with the velcro hook side facing out as shown in the diagram.

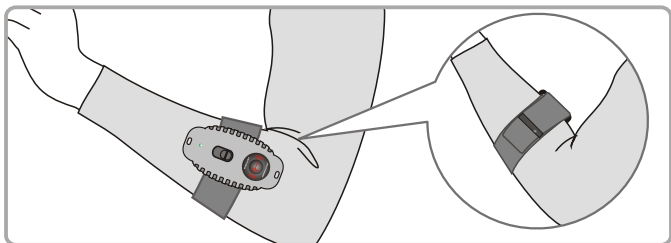
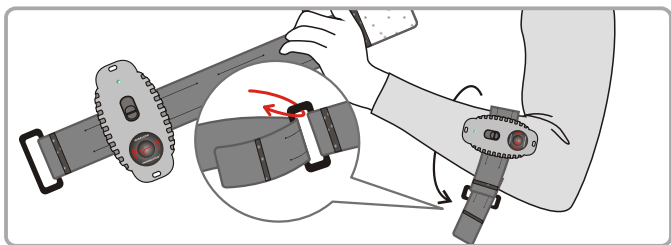

Affix the strap around your forearm and adjust the controller to a comfortable position.

# How to Operate the Controller:

## **|** SPE-005-F Rechargeable Wireless remote controller

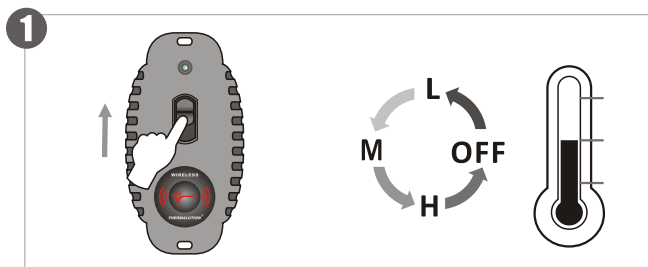

Push the button upward once to adjust between the temperature settings:

Light Color	<b>Green</b>	<b>Orange</b>	<b>Red</b>	<b>None</b>
Temperature	<b>Low</b>	<b>Mid</b>	<b>High</b>	<b>Off</b>

## **Attention !**

! Please adjust the wireless controller to OFF status when you are not using the gear and unplug battery.

! The receiver on your back will vibrate frequently when the battery of the bodysuit is low. ( 2 fast vibrate every 5 mins until drained power. )

! Please do charge the remote controller after each of your dive. Wireless controller power exhausted completely, that will caused the controller unable to arouse the charging circuit to work, so as charge function could be failed.

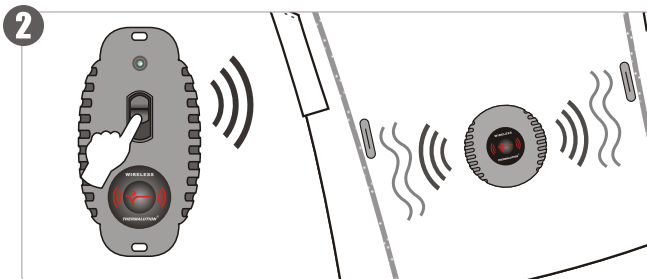

In order to avoid signal disconnection underwater, please use the wireless remote controller at appropriate ( 30-60 cm ) distance to the back receiver of the bodysuit.

- When the setting is on “**Low**” the light indicator on the controller is **green**, it will flash every second and the receiver will vibrate once then stop.
- When the setting is on “**Mid**” the light indicator on the controller is **orange**, it will flash every second and the receiver will vibrate twice then stop.
- When the setting is on “**High**” the light indicator on the controller is **red**, it will flash every second and the receiver will vibrate three times then stop.
- When the setting is on “**OFF**” the light indicator will be off. Receiver will emit an extended vibration then stop.

# How to Connect the Wireless Charging Dock:

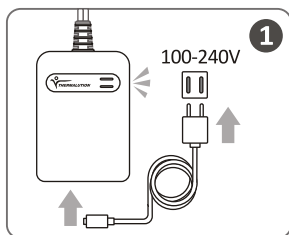

Connect the power adaptor to wall power, and the other end to the Battery Charger. The light indication on the Battery Charger will flash **red > orange > green > off** in sequence, as a self testing to indicate successful connection.

Please wait for lights to goes off before connecting Charging Dock to the charger.

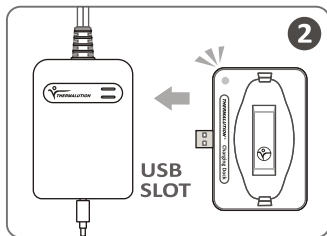

Connect the Charging Dock to USB connector on the Battery Charger. The light indication on the Charging Dock will be shown still red.

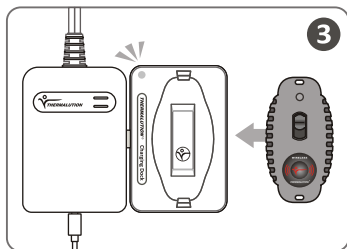

Remove the Forearm Strap from the Wireless Remote Controller, and place the Controller on top of the Charging Dock face up. Make sure there's nothing else between Controller and Charging Dock.

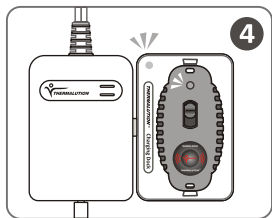

The Controller has started charging and the charging status light indicator will show:

- **Controller** : Red light
- **Charging Dock** : Green flash light
- **Battery Charger** : None

## CHARGE STATUS

	No-load	Charging	Charged
<b>Controller</b>	None	<b>Red light</b>	<b>Green light</b>
<b>Charging Dock</b>	<b>Red light</b>	<b>Green light flash</b>	
<b>Battery Charger</b>	None	None	None

## Attention for Rechargeable Wireless Remote Controller

1. Please charge the Remote Controller after every dive.
2. When the battery of the Controller is low, the light indicator will flash twice every second.
3. Never charge the Wireless Controller under the sun, or anywhere close to heat.

# Important Product Safety Information !

**Please handle your Wireless Charging Dock and its accessories with care. The following suggestions will help you protect your product and its warranty coverage:**

1. Read this manual before use and follow the instructions.
2. Do not store your product in dusty or dirty areas.
3. Do not store your product in high temperature area over degrees.
4. Do not store your product in cold temperatures area under degrees.
5. Do not attempt to open or alter your product as such action may damage the product and void the warranty.
6. Avoid rough handling of your product such as dropping, knocking, or shaking, as it may break the internal circuit boards or mechanics and void the warranty.

## **Attention !**

The product is partially magnetic and metallic materials may get attached to the product. Thus, do not place any bank cards or other magnetic storage media near the product to prevent stored data and information getting erased.

## **Warning !**

Per medical device manufacturers in general, a minimum distance of 15.3 cm (6 inch) between any wireless device and an implanted medical device, such as a pacemaker or implanted cardioverter defibrillator, is recommended to avoid potential interference with the medical device. Thus, a person who has a medical device should follow his/her medical device manufacturer's directions and keep Thermalution's wireless device at a safe distance from the medical device.

# Washing Instructions:

- Hand-wash your heated bodysuit with cold water only.
- Before washing , disconnect and remove battery from pocket.
- Please use clean water to rinse the suit after use.
- Please flush out the salty water from the bodysuit or any grime on the connectors, then store away after it is fully dry. Keep it in a cool and dry place; away from the sun.
- Do not tumble dry. No spin or bleach.



## **! Attention !**

Please flush the bodysuit and the battery connectors with clear water immediately after use, and blow dry with an air gun. This would prevent corrosion caused by salt water. Do not tumble dry.

- ! Do not turn the power on if the connectors are still wet.**
- ! When used in sludge technical diving or salty waters, please make sure to rinse the whole suit and flush both connectors after every use.**
- ! There is limited power remaining in the enclosed batteries. We recommend that you fully charge the batteries before usage. To achieve the optimum condition, the batteries will need to be fully charged and discharged for the first few times. \* Fully charge means over night charging for at least 8 hours.**

# How to Charge the Batteries:

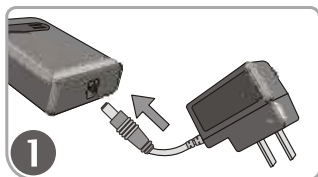

Connect the battery charger to the universal AC power adaptor.

(COE-010-C / 100~240V)

or

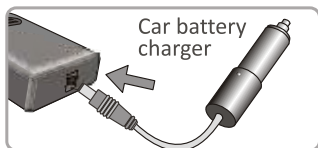

Connect the charger to the cigarette lighter adaptor.

(When using the **car battery charger** / COE-013-A)

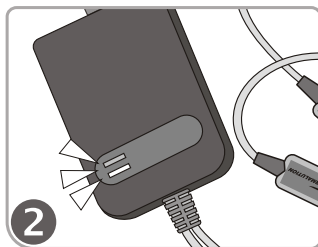

Once connected to power the charger will flash **red > orange > green > off** in sequence as self testing to indicate successful connection. Please wait for lights to switch off before connecting batteries to the charger.

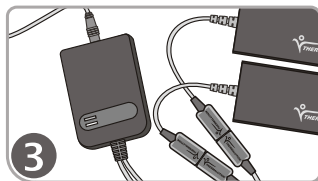

Plug batteries to the dual battery charger (SPE-004-J) to recharge 2 batteries simultaneously.



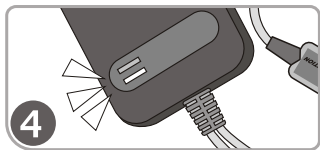

Charge the batteries until the light turns **green**.

The light on the battery charger will indicate the charging status:

- Red light : charging.
- Green light flashing : 90% charged.
- Green light still : 100% fully charged.

### **CAUTION**

- Red light flashing : charging circuit may be overheating.
- Orange light flashing : short circuit.
- If you notice a problem with the charger, remove the batteries and the power adaptor, disassemble all the connectors and contact your local dealer for further assistance.

### **MAINTENANCE**

To keep the battery operating at maximum efficiency, the batteries are required to be fully charged and discharged 2-3 times every 2 to 3 months, if you do not use it frequently.

\* Please check if the heating panel at back still flat, if not please stop using and contact your local dealer for services.

# How to store the bodysuit properly:

When you wish to store the suit, you should follow these general rules:

1. Make sure the power has been turned off.
2. Unplug the batteries from the power connectors.
3. Check the thermal module is cool.
4. Check the controls and cords for any unusual things, such as a crack, any cuts or crimped area in the insulation.
5. Hang the suit on a hanger. Be careful not to put the suit into a sharp hard fold.
6. Loosely wrap the battery cords in a separate loose coil. Always keep the cord loose being sure not to pinch the cord or put it into a severe strain anywhere.
7. When you about to use the suit after storage, make certain that the battery and controller connectors are connected tightly. Insecure connections are the cause for many safety (e.g. overheating) and reliability (e.g. controllers don't work properly) problems.

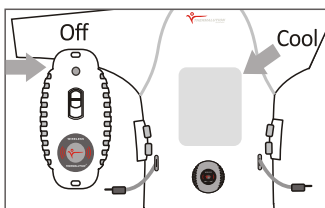
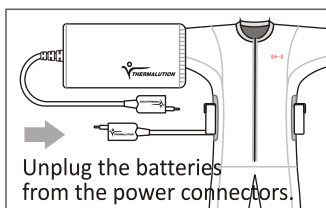



### **Power heated bodysuit use and care:**

Disconnect the batteries from the suit before storing. Such preventive safety measures reduce the risk of starting the heated bodysuit accidentally.

Store out of the reach of children and do not allow persons unfamiliar with these instructions to operate the heated bodysuit. it could be dangerous of untrained users.

Please lay the bodysuit on a flat surface after you take it off.

Never bend or twist the bodysuit.

Do not put weight on top of the bodysuit.

Do not allow the cords to be pinched.

Please disconnect the battery plug when the product is not activated.

Please connect both connectors on the bodysuit before you store it away.

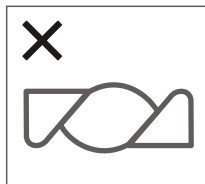
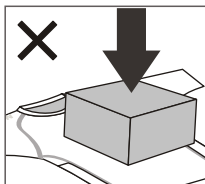

## FAQ:

### What should I look out for when discharging the battery?

To keep the battery operating at maximum efficiency, the batteries are required to be fully charged and discharged 2-3 times every 2 to 3 months if you do not use it frequently.

Because the Thermalution bodysuits are designed for underwater activities, so you must take extra caution when discharging the battery to avoid any accidents. When you are discharging the batteries, please follow these general rules:

1. Discharging the battery in a moderate room temperature environment.
2. Sink the bodysuit in cold water during discharging.
3. Lay the bodysuit flat, unfold and do not put any weight on top of the bodysuit.
4. Never leave the discharging battery unattended.
5. Never discharge the battery in the car, or anywhere under the sun, or close to heat.

### DURING DISCHARGING :

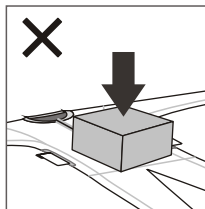
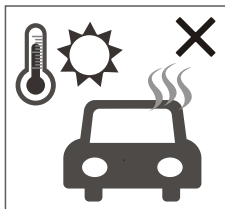
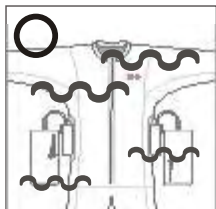

## **Under what circumstances, the Thermalution bodysuit may overheat?**

The heating module on the Thermalution bodysuit may overheat under some exceptional circumstances and/or due to improper usage. It is user's responsibility to use the bodysuit as guided and follow these general rules:

1. You must unplug and disconnect the battery from the connector and heating module when the bodysuit is not in use.
2. If you are using the wireless remote controllers (i.e. products such as Yellow Grade, Yellow Grade Plus, Red Grade, Red Grade Plus) please always double check the vibration of the receiver on the bodysuit itself when you are switching from the wireless remote. There are cases that the indicator light on the remote has been turned off, but the receiver did not vibrate, which means the signal did not successfully passed onto the heating system.
3. If you are wearing Thermalution bodysuits with dry suits, please frequently adjust the heating temperature according to your need. When you feel overheat please switch the temperature level to low, or turn off the system. Moreover, you may wear an under layer underneath the product to avoid skin irritation from heat.
4. When the system is on You should NEVER twist, hard fold and/or put weight on the bodysuit.

## **Warranty exceptions and repair fee?**

Thermalution may charge you a repair fee (including shipping charges) as described in the warranty section. If Thermalution inspects your bodysuit and determines that (i) your product has failed due to or has compatibilities with improper use, (ii) the product has failed due to accident, abuse, neglect, misuse (including connector pin break, battery pin break, over stretch causing exposure of wires, any components besides the thermal system module; etc), unauthorized modification, extreme physical or electrical stress or interference, fluctuation or surges of electrical power, lightning, static electricity, fire, acts of God or other external causes ("Warranty Exception") Thermalution will return your product to you without servicing and may charge you the repair fee. In general, any action that is NOT instructed in the manual, on Thermalution website or recommended by Thermalution will be considered as improper use. For more details, please refer to the warranty section on the Thermalution website.

For further information please refer to  
Thermalution® official website > Q&A page.  
**[www.thermalution.com](http://www.thermalution.com)**

## Warning:



**Read all safety warnings and instructions.**

**Failure to follow the warnings and instructions may result in electric shock, fire and / or serious injury. Save all warnings and instructions for future reference.**

Electrical safety:

Do not abuse the power cable, never use the cord for carrying, pulling, keep cord away from fire or heat equipments, oil sharp edges or moving parts.

Personal safety:

Do not use while you are tired or under the influence of drugs, alcohol, medication, or sleeping, a moment of inattention may result in serious personal injury.

Specific safety rules:

Do not use this heated bodysuit with an infant, child, a helpless person, or anyone insensitive to heat, such as a person with poor blood circulation.

If you have a medical condition making you sensitive to overheating, or you use any personal medical devices, consult the device manufacturer or your physician to determine if use of this product is appropriate.

# Batteries:

## **The SPE-004-J Battery Charger**

Before using the SPE-004-J charger, read and follow the warning notices on this manual.

The SPE-004-J charger is for use with SPE-002-E and SPE-002-C batteries. Do not use with incompatible batteries. The supplied power cable is intended solely for use with the SPE-004-J charger and is for indoor use only.

## **The SPE-002-E Battery**

Before using the SPE-002-E battery, read and follow the warning notices on this manual.

Do not use the battery at ambient temperatures below 0 °C (32 °F) or above 40 °C (104 °F). During charging, the temperature should be in the vicinity of 5 to 35 °C (41 to 95 °F).

Note that the battery may become hot during use. Wait for the battery to cool before charging. Failure to comply with these precautions could damage the battery, impair its performance, or prevent it from charging normally.

Connecting batteries with each other is absolutely prohibited. It may cause serious damage to the battery themselves.

## **When the Battery Is Not in Use**

When the battery is not in use, remove it from the bodysuit and battery charger.

The bodysuit and battery charger would draw minute amounts of current even when off; if left in place, the battery could be drained to the point that it no longer functions.



# Battery Handling Precautions

**DANGER**

**1** Do not disassemble or modify the battery pack. The battery pack is equipped with built-in safety/protection features. Should these features be disabled, the battery pack can leak acid, overheat, emit smoke, burst and/or ignite.

**2** Do not connect the positive (+) and negative (-) terminals with a metallic object such as wire. Do not transport or store the battery pack together with metal objects such as necklaces, hair pins, etc. Otherwise, short-circuiting will occur, overcurrent will flow, causing the battery pack to leak acid, overheat, emit smoke, burst and/or ignite, or the metallic object such as wire, necklace or hair pin can generate heat.

**3** Do not discard the battery pack into fire or heat it. Otherwise, its insulation can melt down, its gas release vent or safety features will be damaged and/or its electrolytes can ignite, possibly leading to acid leakage, overheating, smoke emission, bursting and/or ignition.

**4** Do not use or leave the battery pack near a heat source such as a fire or a heater (80°C / 176°F or higher). If the resin separator should be damaged due to overheating, internal short-circuiting may occur, possibly leading to acid leakage, overheating, smoke emission, bursting and / or ignition.

**5** Do not recharge the battery pack near fire or in extremely hot weather. Otherwise, hot temperatures can trigger its built-in protective features, inhibiting recharging, or may damage the built-in protective features. Therefore it may be charged with an extremely high current and voltage, and, as a result, abnormal chemical reactions may occur, possibly leading to acid leakage, overheating, smoke emission, bursting and/or ignition.

**6** Do not pierce the battery pack with a nail or other sharp objects, strike it with a hammer, or step on it. Otherwise, the battery pack will become damaged and deformed, internal short-circuiting may occur, possibly leading to acid leakage, overheating, smoke emission, bursting and/or ignition.

**7** Do not use an apparently damaged or deformed battery pack. Otherwise, acid leakage, overheating, smoke emission, bursting and/or ignition of the battery pack may occur.

**8** Do not strike or throw the battery pack. The impact might cause leakage, overheating, smoke emission, bursting and/or ignition. Also, if the protective feature in it becomes damaged, it could become charged with an extremely high current and voltage, abnormal chemical reactions may occur, which may cause acid leakage, overheating, smoke emission, bursting and/or ignition.

**9** To recharge the battery pack, use the specifically designed battery charger and observe the recharging conditions specified by PETATECH. A recharging operation under non-conforming recharging conditions (higher temperature and larger voltage/current than specified, modified battery charger, etc.) can cause the battery pack to be overcharged, or charged with extremely high current, which may cause abnormal chemical reactions, possibly leading to acid leakage, overheating, smoke emission, bursting and/or ignition.

**10** Do not directly solder the battery pack. Otherwise, the heat may melt down its insulation, damage its gas release vent or safety features possibly leading to acid leakage, overheating, smoke emission, bursting and/or ignition.

**11** Do not reverse the positive (+) and negative (-) terminals. Otherwise, during recharging, the battery pack will be reverse-charged, which may cause abnormal chemical reactions. Alternatively, it may cause an excessively high current during discharging which may lead to acid leakage, overheating, smoke emission, bursting and/or ignition.

**12** The positive (+) and negative (-) terminals are arranged in a particular orientation. Do not force the connection if you cannot easily connect the battery pack terminals to the battery pack charger or other equipments. Confirm that the terminals are correctly oriented before connection. Reversing the terminals will result in reverse-charging, possibly leading to acid leakage, overheating, smoke emission, bursting and/or ignition of the battery pack.

**13** If the battery pack leaks, and the electrolyte gets into the eyes, do not rub them. Instead, rinse the eyes with clean running water and immediately seek medical attention. Otherwise eye injury may occur.

**14** Do not connect the battery pack to an electrical outlet, vehicle cigarette lighter, etc. When subjected to a large voltage, overcurrent may flow on the battery pack, possibly leading to acid leakage, overheating, smoke emission, bursting and/or ignition.

**15** Do not use the battery pack for a purpose other than those specified. Otherwise, its guaranteed performance will be lost and/or its service life will be shortened. Depending on the equipment in which the battery pack is used, excessively high current may flow through battery pack, possibly damaging it and leading to acid leakage, overheating, smoke emission, bursting and/or ignition.

## **Warning**

**1** Do not use the battery pack in combination with primary battery packs (such as dry-cell battery packs) or battery packs of different capacities or brands. Otherwise, the battery pack may be overdischarged during use or overcharged during recharging, abnormal chemical reactions may occur, possibly leading to acid leakage, overheating, smoke emission, bursting and/or ignition.

**2** If recharging operation fails to complete even when a specified recharging time has elapsed, immediately stop further recharging. Otherwise, acid leakage, overheating, smoke emission, bursting and/or ignition may occur.

**3** Do not put the battery pack into a microwave oven or pressurized container. Rapid heating or disrupted sealing may lead to acid leakage, overheating, smoke emission, bursting and/or ignition.

**4** If the battery pack leaks or gives off a bad odor, remove it from any exposed flame. Otherwise, the leaking electrolyte may catch fire, and the battery pack may emit smoke, burst and/or ignite.

**5** If the battery pack gives off odor, generates heat, becomes discolored or deformed, or in any way appears abnormal during use, recharging or storage, immediately remove it from the equipment or battery pack charger and stop using it. Otherwise, the problematic battery pack may develop acid leakage, overheating, smoke emission, bursting and/or ignition.

## Caution

**1** Do not use or subject the battery pack to intense sunlight or hot temperatures such as: left in a car in a hot weather. Otherwise, acid leakage, overheating and/or smoke emission may occur. Also, its guaranteed performance will be lost and/or its service life will be shortened.

**2** The battery pack incorporates built-in safety devices. Do not use it in a location where static electricity (greater than the manufacturer's guarantee) may be present. Otherwise, the safety devices may be damaged, possibly leading to acid leakage, overheating, smoke emission, bursting and/or ignition.

**3** The guaranteed recharging temperature range is 0 to 40°C(104°F). A recharging operation outside this temperature range may lead to acid leakage and / or overheating of the battery pack, and may cause damage to it.

**4** If acid leaking from the battery pack contacts your skin or clothing, immediately wash it away with running water. Otherwise, skin inflammation can occur.

**5** Store the battery pack in a location where children cannot reach it. Also, make sure that a child does not take out the battery pack from the battery pack charger or equipment.

**6** Before use, carefully study the operation manual and precautions. For further information, contact your nearest PETATECH distributor or representative. Safe keep the manual for future reference.

**7** For recharging procedures, refer to the operation manual of your battery pack charger.

**8** If you find rust, bad odor, overheating and/or other irregularities when using the battery pack for the first time, return it to your supplier or vendor.



## Thermalution® Thermal system Quality Warranty and Service

Dear Thermalution® consumers,  
**Thank you for purchasing Thermalution® products.**

We; Petatech International Co., Ltd. Guarantees this product against defective components, faulty workmanship and any defect in materials associated with the **thermal system only** for a period of 12 months from the date of purchase. Products subjected to the above conditions will be rectified a replacement of the product by Thermalution® authorized distributors / retailers from whom this product was purchased.

### **If your product is faulty within the warranty period:**

Should your Thermalution® product have faults within the warranty period, please return it to the distributor / retailer from whom it was purchased. In most cases the distributor / retailer will send the product to Petatech International Co., Ltd. Taiwan for a repair cost inquiry.

**All Thermalution products have been insured for product liability insurance. Please be insured for safety.**

# Conditions

- 1** The product must have been purchased from Thermalution® authorized Distributors / Retailers. As proof of purchase, retain the original sales docket indicating the date and seller of purchase.
- 2** The warranty applies only to faults caused by defective components associated with the thermal system.
- 3** The warranty does not cover faults caused by failure to comply with the product's instruction manual. Consumers are requested to read the instruction manual before using of Thermalution® products.
- 4** In the event of a failure, Petatech shall be under no liability for any injury or any loss or damage caused to property or products other than the product under warranty. This warranty does not prejudice your rights under common law and statute, and is in addition to the normal responsibilities of the distributor / Retailer and Petatech International Co., Ltd.
- 5** The warranty on this product will be voided if the product is altered ,misuse ,improper handling or storage , tampered, taken apart, abuse, modified or repaired by non-authorized repair centers.

**Thermalution® product number #** \_\_\_\_\_

**Authorized Distributor/Retailer** \_\_\_\_\_

**Country:** \_\_\_\_\_ **Purchase date:** \_\_\_\_\_





---

Scan to  
warranty  
web page !

---

Please refer to Thermalution official web site  
for more warranty policy details:

**[thermalution.com/contact\\_warranty\\_water.html](http://thermalution.com/contact_warranty_water.html)**



**FCC ID : 2AD8XSPE-005**

---

** PETATECH INTERNATIONAL CO., LTD.**

6F., No.101, Zhouzi St., Neihu Dist., Taipei City 114, Taiwan R.O.C.

Tel : +886-2-8751-9998 Fax : +886-2-8751-6887

Contact : [info@thermalution.com](mailto:info@thermalution.com) Visit : [www.thermalution.com](http://www.thermalution.com)